

The Arlington

Plan 4021

Approximately 1999 Sq. Ft.

- Two Story
- 4 Bedrooms
- 3 1/2 Bath
- Two Bay Garage

A



B



C



The Arlington Plan is packed full of features usually found in much more expensive homes. A two story with 4 bedrooms, 3 1/2 baths and almost 2,000 square feet. With a 2 car garage and indoor laundry this plan is already a big hit.

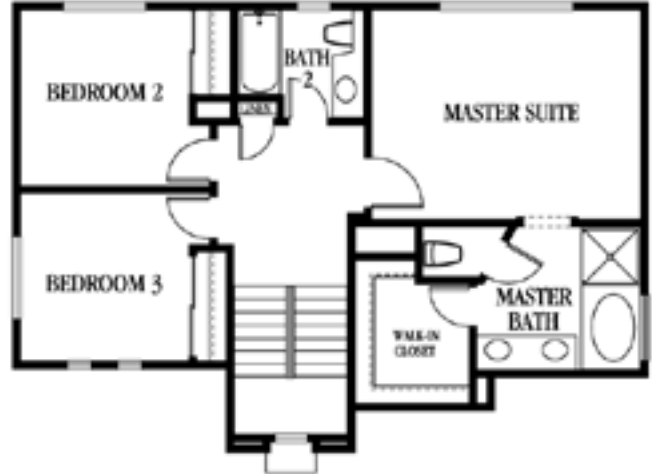

Sales Office Hours
 MON. - SAT. 10:00 AM - 6:00 PM
 SUN. 12 noon - 6:00 PM
 Winter Hours, Close 5:00 PM

WOODSIDE HOMES

Simply The Best. By Design.



Phone 209-595-0140

Stockton, CA 95209



www.woodside-homes.com